

3. Display Shows ER3

When **ER3** appears on the control panel, please reconnect the motor cords to the control panel. Then, reconnect the desk to power, and press down button to reset the system. If **ER3** still appears, please contact your point of purchase for service or repair to your unit.

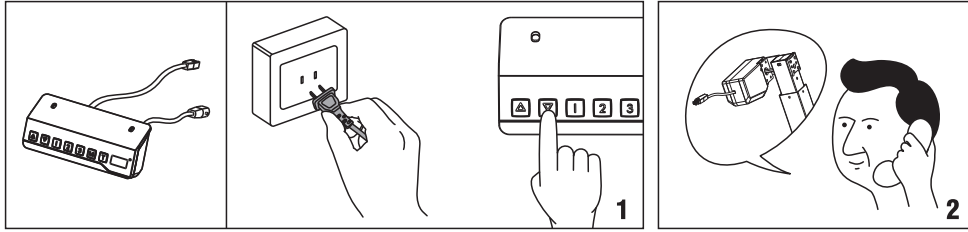

4. Display Shows ER5

When **ER5** appears on the control panel, please check the AC adapter is original or not, if not, replace an original AC adapter. If ER5 still appears, lighten the load on the desk. If it still doesn't work, please contact your point of purchase for service or repair to your unit.

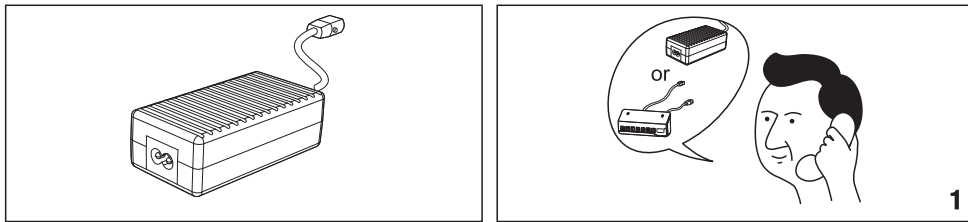

5. Display Shows Control Panel Problems

If the control panel has no response or can't adjust the desk, please contact your point of purchase to replace the control panel after confirming the desk is properly connected to power. If the new control panel works, please contact us to replace the original control panel. If the desk still doesn't work, please contact your point of purchase for service or repair to your unit.

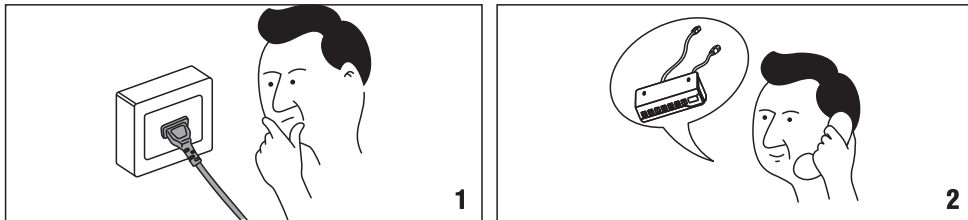

6. Can't Operate

If the desk doesn't work, please turn the power off, and restart the system. If it still doesn't work, please contact your point of purchase for service or repair to your unit.

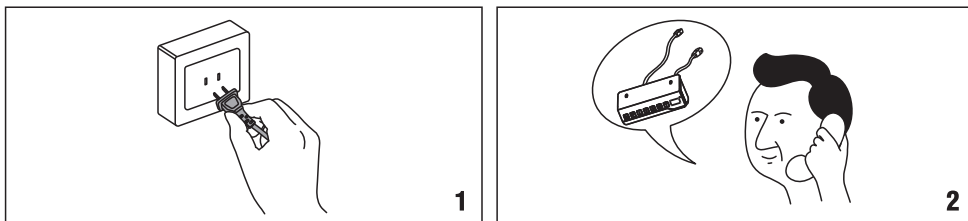

Digital Control Panel For Electric Height Adjustable Desk

User Guide

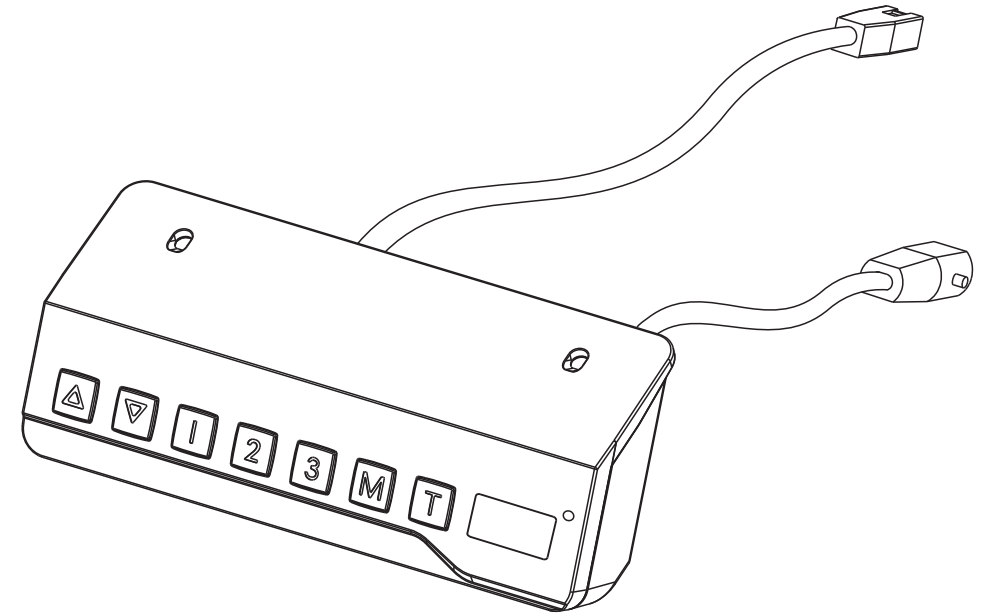

Model: T150

1

Operating Control Panel

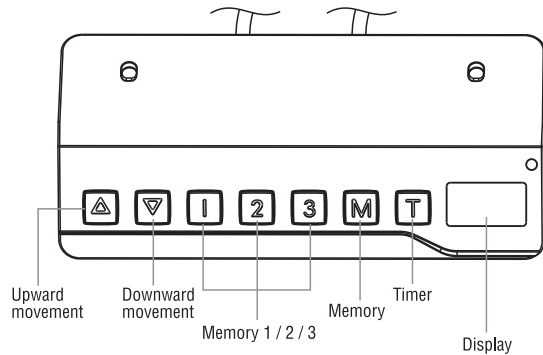

Operation Instruction:

1. When the system is powered on, you will hear a beep and the existing desktop height will be displayed on the controller.

2. Upward movement

Downward movement

Press the "" or "" and do not release until the desk reaches the desired height. If the motor continuously operates for a relatively long period of time, the overheat protection will activate. The control panel will work normally again after approximately 20 minutes.

3. Memory Mode

To store a certain height in the controller's memory, first press "M". The letter "S-" will be displayed. Now press "1", "2", or "3" within five seconds to store the current height in memory. The "1", "2", or "3" buttons can each store a different height. Once in memory, you can select any of the 3 height settings found in the controller's memory by pressing the corresponding button. Pressing any buttons (except for "T") will stop the automatic adjustment.

4. Reset Mode

If the system is required to reset, reconnect the system. Then, press the "" button until "RST" is displayed. Continue to press the "" button, the desk will move upwards a little bit and automatically come to a stop. The system is successfully reset.

5. Time Reminder

To set the time reminder, press "T" found on the controller. The display will flash "0.5h" which means 0.5 hour. Press the "" repetitively to increase 0.5 hours at a time. The maximum timer setting is two hours. The timer is set when the digit stops flashing and the light in the top right corner of the controller is on. When the timer has reached the set time, the buzzer beeps, reminding the user to adjust his/her working position. Once a timer setting has expired, the unit's timer is cancelled. To de-activate the timer, press the "T" five times until the current height is displayed and the light found in the upper right side of the controller is off.

6. Power-saving Mode (1 Minute)

When no actions are made for over 1 minute, the system will enter power-saving mode. Touch any button to enter operation mode.

7. Switch measurement between cm and inch

The preset measurement shown on the display is cm. If you would like to change cm to inch, please restart the system and press the button "" for 3 seconds. After the buzzer beeps twice, the measurement is successfully reset. If you would like to switch inch back to cm, please restart the system and press the button "" for 3 seconds. After the buzzer beeps once, the system is successfully switched to cm measurement again.

8. Collision Avoidance Settings:

Press and hold the "M" and "T" buttons together for 5 seconds until you hear the controller beeps twice indicating you are in the Collision Avoidance Settings Mode. The screen of the controller will display the current sensitivity level (level 3 by default). Press the "" or "" button to adjust the desired sensitivity level. When you are finished selecting the new level, press the "M" button to save the sensitivity level. The Collision Avoidance Settings Mode will automatically exit if there is no further activity within 8 seconds.

Note: You must press the "M" button within 8 seconds of selecting the new sensitivity level to save the new setting or the unit will revert to the previous setting level.

Collision Avoidance Sensitivity Levels: 0-5

0: Turn Off Collision Avoidance.

1-5: Sensitivity Setting - Level 1 is the lowest sensitivity and the level 5 is the highest sensitivity.

Trouble Shooting

Below are the possible error codes that may be displayed on the control panel.

Error Code	Description
ER1	Overload in downwards direction has occurred and needs to be restart power.
ER2	Over-heating in the controller has occurred and needs to cool.
ER3	Motor cable connection fault and needs to be reset.
ER5	Voltage overload has occurred and needs to replace an original AC adapter. Or desk overload and needs to lighten the load.

Note:

- Self-protection function: the unit will enter protective mode if the system operate in excess of two minutes with "HOT" on the controller display. The system will reset and return to normal operation after approximately 20 minutes.
- Overload protection mode: while operating, if the load on the desk is over weight capacity, the system will enter into an overload protection mode. This will protect the system from damages caused by exceeding weight. When this happens, the desk will move downward approximately 30mm and come to a stop with the current height displayed.
- Attention: NEVER remove or turn off the power in order to reset the unit when it is in a protective mode or "HOT" state.

2

Repair Guide

In Front

This repair guide intends to help you identify and solve the minor problems caused by unusual operation of the electric system of our sit-stand desk. The simple procedures in this manual are easy to follow and capable of solving the most problems happened in everyday use.

Errors

1. Display Shows ER1

When ER1 is shown on the control panel, please check if the load is over weight capacity. If not, please reconnect the desk to power, and restart the system. If ER1 is still shown on the panel, please contact your point of purchase for service or repair to your unit.

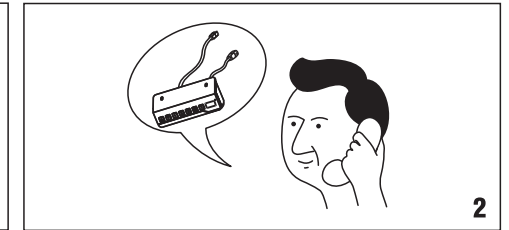
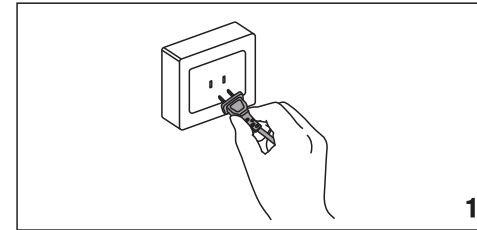

2. Display Shows ER2

Your desk is in thermal protection mode should ER2 appear on the control panel. This is normally nothing to worry about, and usually is an indication that the system has experienced above-normal operating temperature due to a number possibilities including environment, desktop weight, or activity that is above rated specifications. Allow your desk to cool down and remain idle for approximately 20 minutes and the ER2 continue to be displayed on the control panel after the allotted time, please contact your point of purchase for service or repair to your unit.

